

Geberit bathtub drain with turn handle and inlet, d52, length 23 cm, with ready-to-fit-set and straight connector

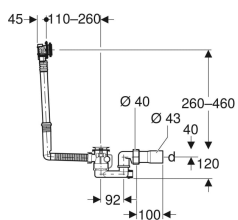

Example image



Application purposes

- For bathtubs made of steel, plastic or cast iron
- For standard-size bathtubs
- For bathtubs with valve hole \varnothing 52 mm

Characteristics

- Quality-monitored in accordance with EN 274-3
- With overflow and inlet
- Inlet jet can be aligned
- Double-sided seals on drain and overflow

Scope of delivery

- Waste outlet
- Trap
- Overflow head with inlet
- Elbow tap connector 90° with MasterFix, 1/2", radial-sealing

- Overflow head with extendible mount can be fastened

Technical data

| | |
|-------------------------|----------|
| Line noise at 3 bar | 15 dB(A) |
| Sound class | 1 |
| Inlet capacity at 3 bar | 0.35 l/s |
| Discharge rate | 0.85 l/s |
| Overflow discharge rate | 0.6 l/s |
| Depth of water seal | 50 mm |

- Straight connector made of PE-HD, \varnothing 43 mm
- Ready-to-fit set
- Protection box
- Fastening material

| Art. no. | Colour / surface | DN | d, \varnothing |
|--------------|---------------------|----|------------------|
| 150.712.21.1 | gloss chrome-plated | 40 | 40/43 mm |

Accessories

- Geberit connection set for bathtubs made of acrylic, with overflow